

Art of Youth

*Pope High School
February 6th & 7th 2010*



SAPA - Southern Association for Performance Arts

ART OF YOUTH

Alan C. Pope High School
3001 Hembree Road
Marietta, GA 30062
February 6th & 7th, 2010

The Alan C. Pope Band Parents' Association welcomes you to our Art of Youth at Pope High School. We thank you for attending our event and hope that you have a rewarding experience at Pope High School.

Admission Prices: As per the official SAPA admission prices, a one-day ticket will be \$8.00. A two day pass will be \$12.00. Each unit will be allowed to bring **seven** staff people into the show in addition to the marching members. Additional passes may be purchased at check-in. SAPA badges will be honored for circuit members. Wrist bands are required for all spectators, guard members, all staff, as well as for equipment crew and chaperones

Seating: Spectators will sit to the left of the spectator entrance. Performers are required to sit on the opposite side of the gym. Performers are encouraged to support all units.

Parking: Spectator parking will be in the lot located to the front of the building (see map). Equipment drop-off and parking will be to the right, in the bus parking lot.

Unit Check In: Unit check in, as shown on enclosed map, is located on the right side of the school near the green house. Unit check in signs will be posted. Be prepared to declare the number of marching members. Penalties will be assessed for false declarations. Marching members and **seven** staff will be admitted. Additional staff must purchase tickets; no one including equipment crew or chaperones will be admitted to the gym without a wristband. Units must check in one hour prior to performance time. **Guard members and staff must check in together.**

Overnight Housing: We will be offering housing **on-site** for a charge of **\$3.00** per competing member for one night. Housing contracts and waivers in this packet should be emailed to Martha Gribble at gribs4gmma@comcast.net to make reservations. Units with reservations will be provided a room at unit check-

in once the payment is received.

Cooking is not allowed in any of the classrooms or cafeteria. We ask that you keep your area clean and place all trash in trash cans (see enclosed forms).

Practice Time: The cost is \$20.00 per half hour. Units making housing and practice arrangements must settle their financial responsibilities at the unit check in when arriving at the show. Any unit with unsettled bills will not be allowed to compete.

Practice time is on a first come first served basis Saturday night after the competition ends and Saturday morning before the competition begins. Practice time will be scheduled through Martha Gribble at gribs4@gmma@comcast.net (see enclosed practice form).

Dressing Facilities: Available on site - please vacate ASAP after performance. Please do not leave valuable personal items in dressing area. Please leave dressing area clean and neat.

Equipment Protection and footwear: The maximum allowable tarp size for any unit is 50' X 90'. All equipment tips on rifles, pikes, and sabers must be padded and taped; this includes PVC pipes. Any props used must be protected so as not to damage the floor. Soft-soled shoes need no added protection. Hard-soled shoes must be taped. Performers MUST wear shoes at all times when NOT in the competition area. Penalties will be assessed for violation of this rule.

Inspection: Located in warm up area.

Equipment Unloading: Equipment will be unloaded in the upper "bus" parking area to the right of the school entrance. Equipment will enter the school through the door to the back hall just behind the gym. Tarps and props will be stored in the back hallway as well as the 2 hallways running off of the back hall, in order of performance. Please be prepared to have someone with your equipment at this time. You will be allowed to unload your equipment one hour prior to your performance and must reload as soon as performance is over.

Tabulating and Judging Area: Please do not enter either area or communicate with judges. Performance tapes will be available after your performance at a table adjacent to the tabulation/judging area. Score sheets and recaps can be picked up after the show in the tabulation area.

Sound Table: A sound system will be provided by SAPA with mixing board, variable speed CD player, amplifier, etc. Bring music tapes and CDs to the sound

table prior to your performance. Make sure tapes are cued in the proper place. A representative should stay with the SAPA sound person during your performance. You should have a clearly labeled back-up recording. Sound checks should be done prior to the show or, on a limited basis, during breaks and will take place at the sound table. Volume is controlled by SAPA.

Time Line: Vertical Time Line

Warm-Up area: **Body warm-up** will be in the Band Room see enclosed map for location. **Equipment warm-up** is down the hall in the small gym (see enclosed map) for location. **SPINNING IS NOT ALLOWED ELSEWHERE IN THE BUILDING.**

Percussion warm up will be held in the stadium area. There is to be NO warming up in the parking lot! Because there is ACT testing in the building, this will be strictly enforced.

Floor Refolding: Floor refolding will be done outside in the equipment unloading area adjacent to the Main Gym. In case of inclement weather, floor refolding will be done after the show or during breaks.

First Aid is located in room 504. (See enclosed map).

Hospitality will be located in the small room off of the cafeteria or concession area. We will be serving hot food for staff and judges; snacks and beverages will be available throughout the day.

Concessions: There will be two concession stands. The cafeteria will house meals and a full line of beverages and snacks. The concession stand outside the gymnasium close to the spectator entrance will have snacks and drinks. The concession stands will be open both days.

Score Sheets and Recap can be picked up after the show at the tab table.

Critique: Contest Director will determine the details. The chorus room will serve as the critique room as well as the Directors' Room.

Video Taping: Due to copyright restrictions. **NO ONE NOT EVEN THE CONTEST SPONSOR** is to videotape any part of the contest, except a unit videotaping **THEIR OWN** program. There will be video passes provided for each unit at check-in. Due to copyright restrictions, there is **NO** selling of contest videos.

Vendor Sales Costs:

Competing units – \$25.00

Non Competing Units & Commercial Vendors will be charged \$50.00. Contact Kathy Miller at kmmill4072@bellsouth.net

Emergency Contact:

Marsha Mourdock: cell—770-378-6563

Event Coordinator: Please direct any questions you may have to our event coordinator, Marsha Mourdock at mawith7kids@comcast.net. or call 770-485-0698 (home), or 770-378-6563 (c).

Once again, welcome to Pope High School. We hope our contest meets your expectations in every way.

Best regards,

Marsha Mourdock

2010 Art of Youth Contest, Coordinator

The following maps and directions are enclosed in our packet:

Driving directions, traffic flow, Pope facilities map, performance flow, and floor area.

Directions to Pope High School

**Alan C. Pope High School
3001 Hembree Road, Marietta, GA 30062**

From Interstate 75

Take I-75 to Exit 267 A/Canton Rd Connector
Take Canton Road Connector north to first traffic light
Make a right onto Sandy Plains Rd
Stay on Sandy Plains Rd for about 3.5 miles.
Turn Right on Post Oak Tritt Rd (at the McDonalds)
Stay on Post Oak Tritt Rd for about 2 miles
Make a left on Hembree Rd. Follow Hembree for about 1 mile.
Pope is on the left side after the bridge.

From Sandy Springs

Go North on Johnson Ferry Rd. past Upper Roswell Rd (Hwy 120)
Go left on Lassiter Rd at light
Go around large curve to right and you will come to a three way stop
Turn left on Hembree Rd
Pope will be on your right after the white picket fence

From Georgia 400

Take GA 400 to Exit 7/Holcomb Bridge Rd
Turn on Holcomb Bridge Rd
Stay on Holcomb Bridge Rd. to Alpharetta Highway; turn left onto Alpharetta Highway
Go to third light, bear right and cross intersection onto Magnolia Street
Stay on Magnolia and it will turn into Shallowford Rd.
Go past Johnson Ferry Rd. to Lassiter Rd. and turn left
Turn right at the three way stop onto Hembree
School will be on your right

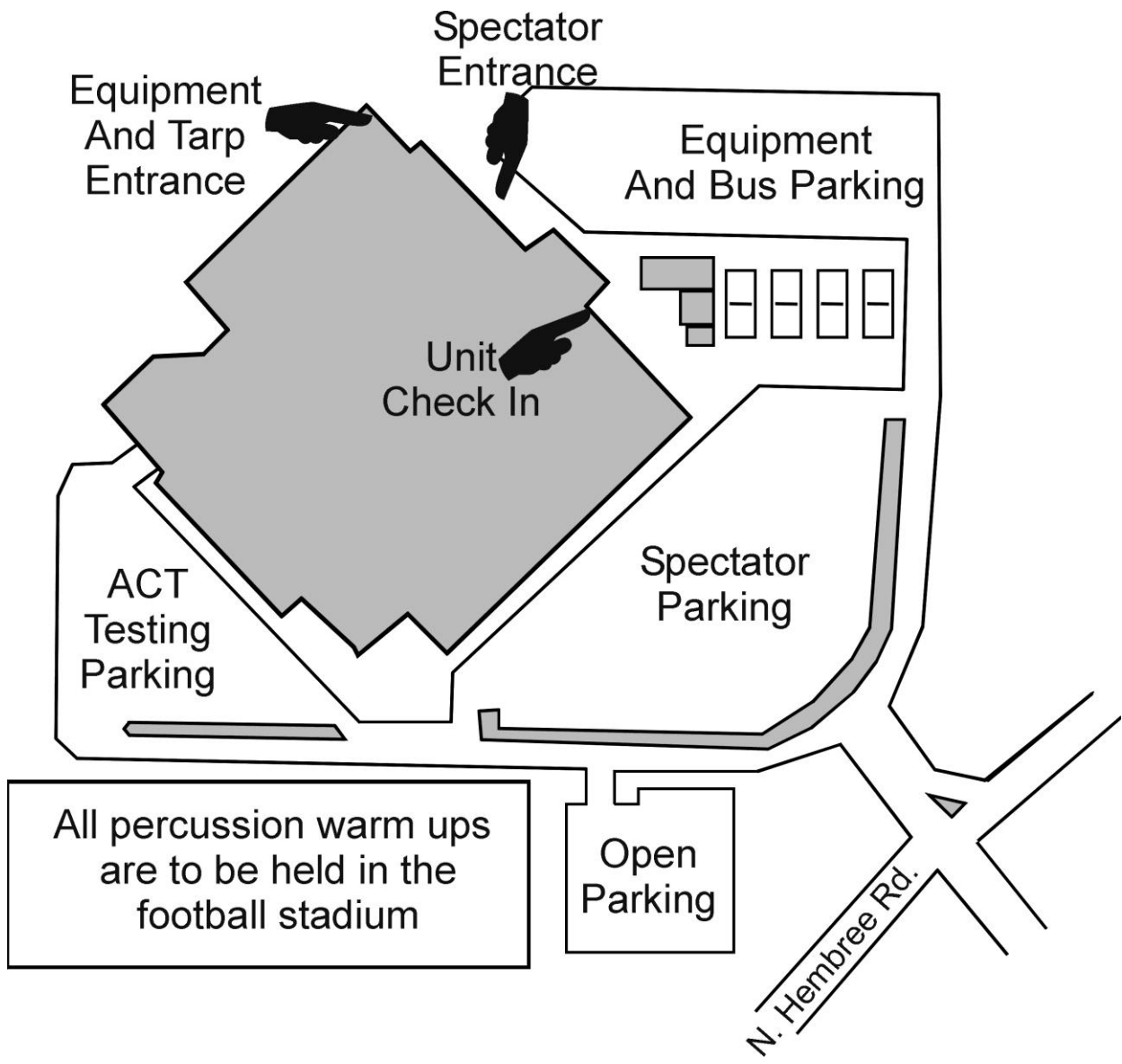

TRAFFIC FLOW

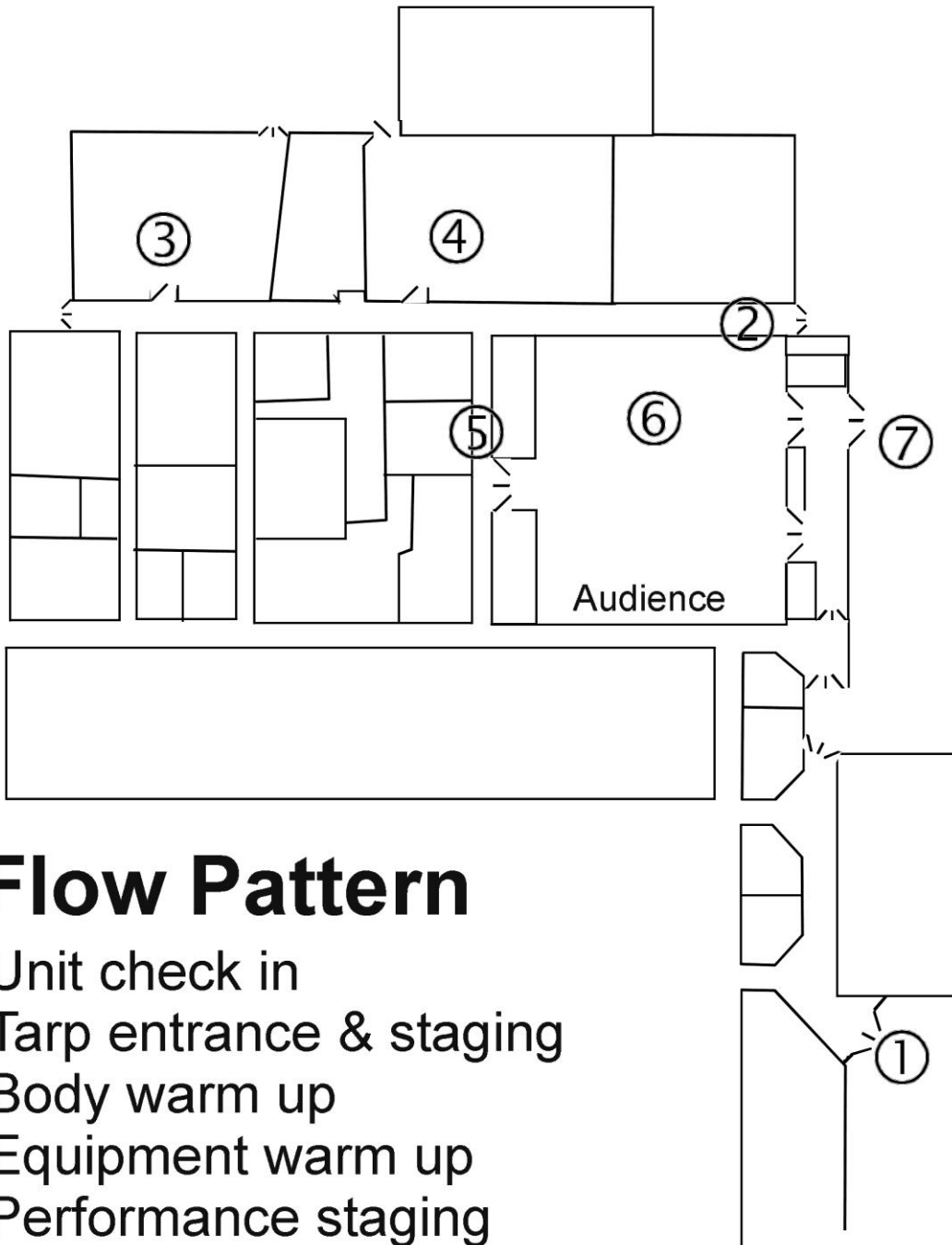

Flow Pattern

- 1-Unit check in
- 2-Tarp entrance & staging
- 3-Body warm up
- 4-Equipment warm up
- 5-Performance staging
- 6-Performance area
- 7-Exit and tarp folding

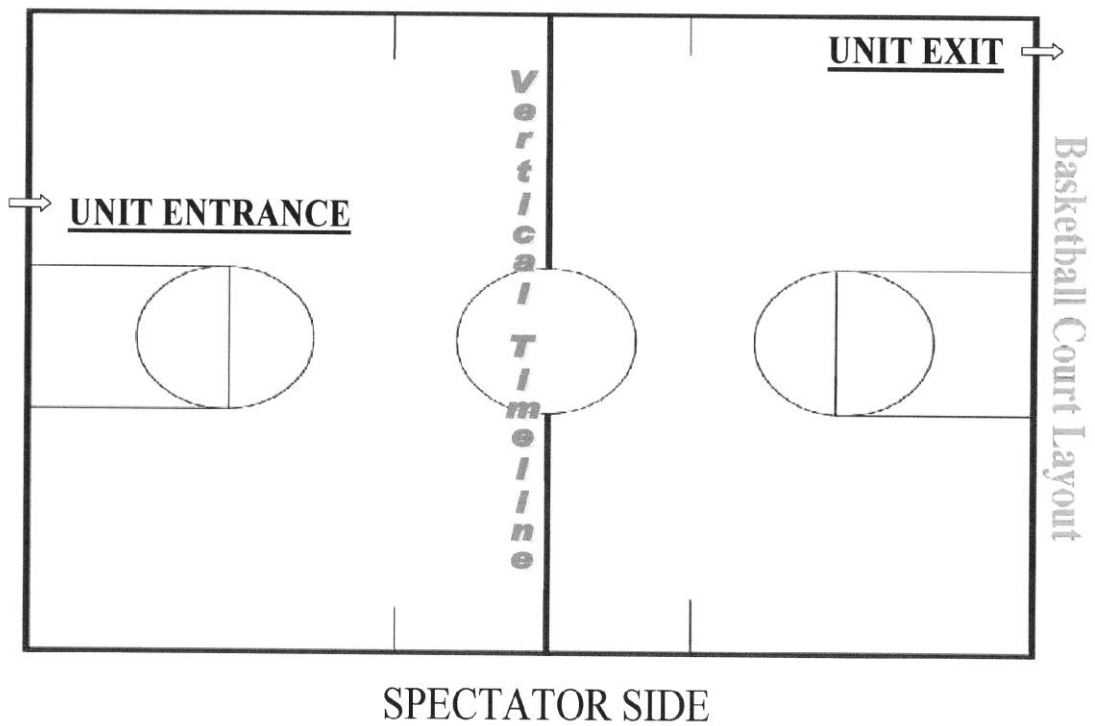

FLOOR AREA

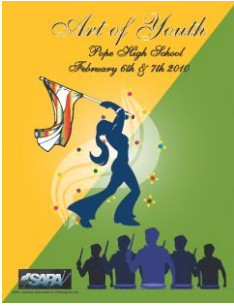

Practice Site Contract for "ART OF YOUTH"

Unit Name _____

Name of Contest _____

Person to receive correspondence _____

Address _____

City, State, Zip _____

Email _____ Phone _____

We would like to contract for hours of practice time as follows:

We would prefer times on _____ between _____ and _____
(Date)

We would prefer times on _____ between _____ and _____
(Date)

We would prefer times on _____ between _____ and _____
(Date)

We understand the cost for practice to be \$20.00 per half hour We also understand that if the contracted times are not used or needed, then we will still be obligated for the full price of the time contracted UNLESS suitable arrangements can be made with the contest sponsor PRIOR to the time assigned. The owed amount will be paid at unit check-in prior to competing.

Make checks payable to: PBPA _____

Signed by _____

Position _____

CONTACT: Martha Gribble at gribs4gmma@comcast.net

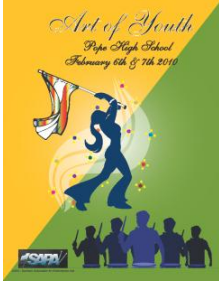

Housing Contract for "ART OF YOUTH"

Unit Name _____

Name of show _____

Person to receive correspondence _____

Address _____

City, State, Zip _____

Email _____ Phone _____

We would like to contract for overnight housing for a cost of \$3.00 per marching member for one night.

Arrive _____ at _____
(day and date) (time)

Depart _____ at _____
(day and date) (time)

No. of guard members staying: _____

All money due will be paid at unit check in. Make checks payable to PBPA.

Signed by _____

Position _____

CONTACT: Martha Gribble at gribs4gmma@comcast.net

(Remember to include the housing waiver)

**Housing Waiver
Art of Youth—Alan C. Pope High School
6 and 7 February 2010**

Participating Guard/drum line _____

As director of the above referenced winter guard/drum line, I take full responsibility for any damages caused by, or injuries involving students, members, staff, and chaperones for our unit. As guests of Alan C. Pope High School, we agree to be liable for loss or damage to equipment or facilities on our assigned areas brought about by unauthorized use, damage or alteration by any representatives of our organization. I understand that my unit will not be permitted to participate on later shows until any substantiated claims for loss or damage have been settled.

My unit , my unit’s representatives and I will ensure that all trash is removed from areas assigned for our uses and will be placed in designated receptacles or bags prior to our departure from the onsite overnight location.

I further acknowledge that abusive language or behavior, incidents of vandalism or other abuse of the facilities attributed to representatives of my unit may result in disqualification from this or future contests.

I also agree that Pope High School, the Southern Association of Performing Arts and the Pope Band Parents Association will not be held liable for any articles lost or stolen from my group while we are on the PHS campus.

During our stay, I certify that (1) MY MEMBERS WILL BE UNDER ADULT SUPERVISION AT ALL TIMES, (2) THAT NO EATING OR DRINKING WILL TAKE PLACE WITHIN THE CLASSROOMS OR HALL AREAS OUTSIDE OF CLASSROOMS, (3) THAT NO ONE IN MY GROUP WILL SMOKE ON THE PHS CAMPUS, (4) THAT OUR MEMBERS WILL RESTRICT THEIR MOVEMENT ON THE PHS CAMPUS TO AREAS DESIGNATED BY POPE BAND PARENTS ASSOCIATION AND SAPA OFFICIALS FOR THE CONDUCT OF THE CONTEST AND THE SAFE ACCOMODATIONS OF PARTICPANTS AND SPECTATORS.

DATE

SIGNATURE OF DIRECTOR

DIRECTOR’S PRINTED NAME

Art of Youth
Pope High School
February 6th & 7th 2010

HOT DOGS \$1.50

CHEESE NACHOS \$2.00
w/chili \$2.50

PIZZA \$2.00/slice

PORK BBQ SANDWICH \$3.00

GRILLED CHICKEN ON ROMAINE SALAD \$3.00

CANDY BARS, SUNCHIPS, POTATO CHIPS \$1.00

COFFEE, HOT CHOCOLATE, SODA, WATER \$1.00

GATORADE \$1.50



SAPA - Southern Association for Performance Arts

LOCAL CONTACT LIST

COBB COUNTY POLICE non emergency number 770-499-3911

FAST FOODS McDonalds, Subway, Wendy's,
Zaxby's all located on Johnson
Ferry

FLORIST Raelene's 736 Johnson Ferry Road 770-565-2217

GARAGES Good Year Tire Center 770-992-7977
Johnson Ferry Road

East Cobb Auto Center 770-641-9906
2955 Johnson Ferry Road

GAS STATIONS BP
Corner OF Johnson Ferry and Shallowford Roads

Shell
Corner of Johnson Ferry and Lassiter Roads

GENERAL MERCHANDISE Target 770-321-8545
3040 Shallowford Road

Wal-Mart 770-640-7225
3100 Johnson Ferry Road

HOSPITAL/URGENT CARE Wellstar Kennestone Hospital 770-793-5000
677 Church Street
Marietta, GA 30060

Directions:

- ~Turn right out of Pope High School onto Hembree Road
- ~Turn right on Post Oak Tritt Road (stop sign)
- ~Turn left on Sandy Plains Road (light)
- ~Turn left on Canton Road, (light) Continue-Canton Road becomes Church Street

Total 8 .5 miles

Wellstar Urgent Care 770-977-4547
3600 Sandy Plains Road
Marietta, GA 30062

Directions:

- ~Turn left out of Pope High School onto Hembree Road
- ~Turn left on North Hembree Road (watch for street sign)
- ~Turn left on Shallowford Road (light)
- ~WellStar is on the right at intersection of Shallowford Road and Sandy Plains

(light)

Total 2.28 miles

GROCERY STORES

**Kroger
3162 Johnson Ferry 770-650-6673**

**Publix
4401 Shallowford Road 770-640-6200**

PHARMACIES

**CVS
1099 Johnson Ferry Road 770-973-1810**

PIZZA

**Amore's
4401 Shallowford Road 678-822-2222**

TOWING SERVICE

Falcon Towing 770-422-3065

RESTAURANTS

**Caribou Coffee
1275 Johnson Ferry Road 770-971-5010**

**SOBA Bistro and Bar
1060 E. Piedmont Road 770-971-1888**

**My Friend's Place
1209 Johnson Ferry Road 770-971-0124**

**Fuji Hana
1255 Johnson Ferry Road 678-560-8070**