

Creekview High School
Winter Guard Competition
Canton, GA
January 16, 2010

Dear Directors and Instructors,

We are looking forward to your participation at the Creekview Winter Classic. We are very excited to be hosting our first winter guard competition and are looking forward to a great experience! Creekview has a great facility for a guard show and we feel that you will have a very smooth day. The following packet of information should answer all of your questions about our facility and our contest. Also included are campus maps, concession menu and other helpful information.

CONTEST TIME: We do not yet have a schedule. Please continue to check the SAPA website for this information. We estimate the show to start around noon.

EMERGENCY CONTACT NUMBERS: (DAY OF SHOW)

Lisa Adams 770-827-8907

Rob Opitz 404-245-7239

ADMISSION: Per SAPA guidelines, admission will be \$8.00 for a one day pass. Upon payment, you will be given a wristband which must be work around the wrist and visible for admission to the gymnasium.

CHECK-IN: Check-in for competing units will take place in the back hallway of the school. You will need to use the middle entrance to the school and come through the double doors closest to the tennis courts. Your check-in process will go much faster if you have all forms filled out in advance! The following will need to be provided at check-in:

1. Number of guard members
2. Rehearsal fee(\$50.00 per half hour)—MUST BE SCHEDULED IN ADVANCE
3. COMPLETED Spiel Sheet -printed legibly!

At check in you will receive:

1. Staff/chaperone passes (per unit) Additional passes may be purchased at check-in for \$8.00 each
2. Performing units will be receiving hand stamps
3. Confirmation of equipment unloading time

EQUIPMENT UNLOADING/STORAGE: A map of the school is attached. Please be sure and give to your equipment crew so they will be able to find the unloading area upon arrival. **Because of the large number of units competing, you will only be allowed to unload one hour prior to your performance.** All units should reload as soon as their performance is over.

FLOOR REFOLDING: Floor refolding will take place in the back parking lot in the roped off area, you will be directed to that area after your performance.

EQUIPMENT AND PROPS: All equipment and props must be padded and taped appropriately. Please check all your equipment carefully and ensure that it is well done to prevent penalties and/or damage assessments.

WARM-UP/TIME LINE: We will have a horizontal time line. Body warm-up will take place in the cafeteria area and equipment warm up will take place in the cafeteria area. There is ample space available outside, behind the school for additional warm-up.

SOUND: Please provide a clearly labeled CD or tape. It is recommended that you have a back up available, and if at all possible, have someone at the sound table during your performance. Sound/Speed checks may be done before and between performances and at breaks, on a limited basis.

TABUATION /JUDGING AREA: Please stay out of the roped off judging area, and do not attempt to communicate with them while they are working. In addition, the area directly behind the judges' area must

stay clear of spectators and video cameras. Please do not approach the tabulation table. Performance tapes will be available after your performance at a table adjacent to the tabulation table.

PRACTICE TIME: Limited practice time will be available across the street at Creekland Middle school in the gym and cafeteria. It is scheduled on a first come first served basis contact Lisa Adams if you would like some floor time.

CRITIQUE: Critiques will be located in the drama room, which is located across the band room and right beside the staff and directors hospitality room.

CONCESSIONS: Our concession stand will be opening at 8:30AM and will close 30 minutes after the close of the show. There will be a large room adjacent to the concession stand for rest and relaxation. A complete menu has been included in this packet.

HOSPITALITY: The Judges Hospitality Room is located in our percussion room, which is located on the back hallway from the gym. When you exit the gym from the backside you will turn left and go to the last door on the left for the judges' hospitality. There will be signs once you get into the hallway. Please remember that that this is for judges only.

The Director and Staff Hospitality Room is located in our chorus room, which is located on the back hallway from the gym. When you exit the gym from the backside you will turn left and go to the next to last door on the left for the staff and directors hospitality. There will be signs once you get into the hallway. Please remember that that this is for directors and SAPA officials only.

First Aid: The First Aid station is located in the back foyer of the 800 hallway. If you leave the gym from the front entrance you will turn left and go to the end of the 400 hallways and then turn left again and you will see the first aid station directly in front of you. There will be signs to help you find it once you get into the hallway.

VENDORS: There will be an "official" event t-shirt available in our vendor area. There will be a wide variety of vendors. Stop by and check out the vendors' area, which is located in the hallway between the concession stand and the main entrance.

Thank you so much for choosing to come to Creekview High School Winter Classic. We wish your students the best of luck in their performances, and we look forward to seeing you on January 16th! If you have any questions please don't hesitate to contact me before the show.

Sincerely,

Lisa P. Adams

Phone number: 770-827-8907

Email address: lisa.adams@cherokee.k12.ga.us

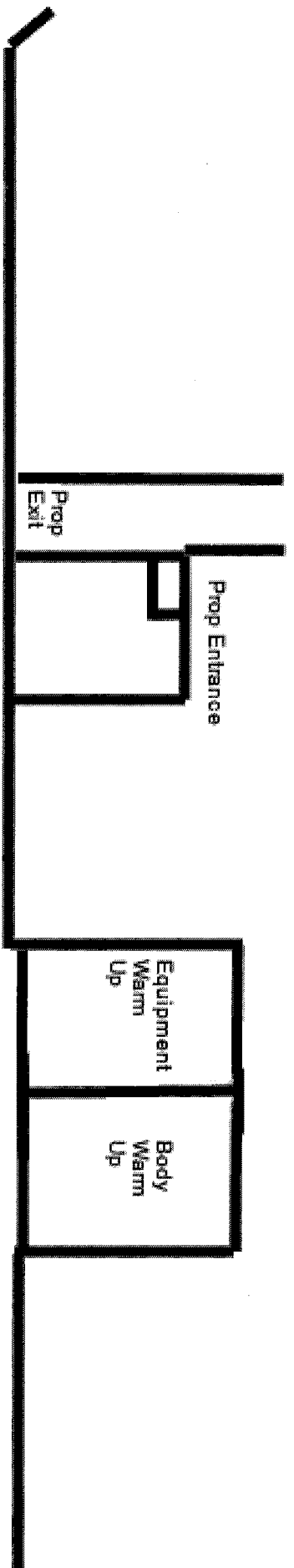

Unit Check-In

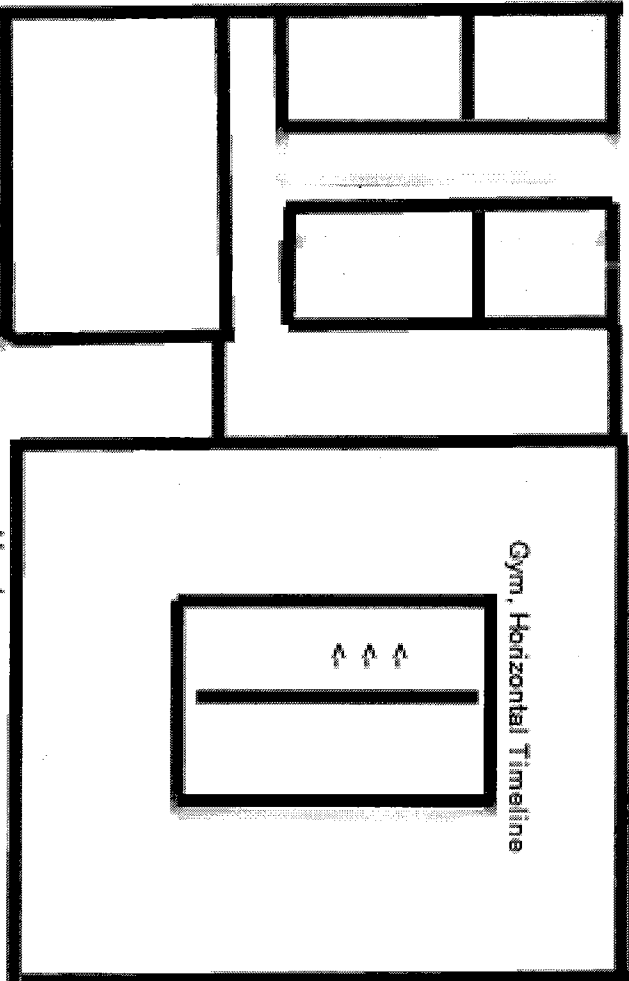

<- Parking for Buses/Cars
in Large Parking lot
Trailers/Trucks around back of school

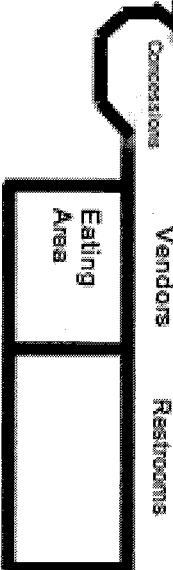

Gym Entrance

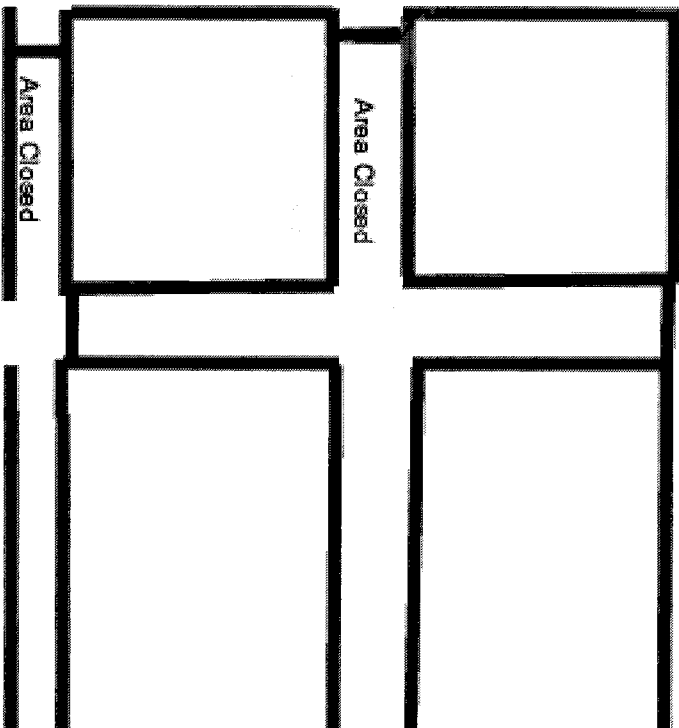

Owens Store Road

Directions

From Woodstock, take I-575 North to Exit 19A, (GA Hwy 20 East). Turn right at the off-ramp and proceed east on Hwy. 20 for approximately 6.5 miles. Turn right onto East Cherokee Drive and proceed 1.2 miles south, passing Macedonia ES on your left, until you come to Owens Store Road. Turn left on Owens Store Road and proceed 1.2 miles. Creekview HS will be on your right, and Creekland MS will be on your left.

From Cumming, Take HWY 20 West. Turn left on E. Cherokee Drive. After approximately 1.2 miles, turn left on Owens Store Road. Proceed approximately 1.2 miles, and the high school will be on the right, and the middle school will be on the left.

From Roswell, take HWY 140 West. Turn right on E. Cherokee Drive. Follow E. Cherokee Drive until you see Woodmont subdivision on your right (approximately a 12-minute ride from 140). Turn right on Owens Store Road, which is the next right after you pass the Woodmont subdivision. Proceed approximately 1.2 miles, and the high school will be on the right, and the middle school will be on the left.

Concession Stand Menu

| | |
|---|--------------------------------------|
| Hamburgers \$2.50 | Cheeseburger \$2.75 |
| Cheeseburger with Chili \$3.00 | Veggie Burger \$2.50 |
| Chic-Fil-A Sandwich \$3.50 | Hot Dog \$2.00 |
| Hot Dog with Chili \$2.25 | Hot Dog with Chili and Cheese \$2.50 |
| Corn Dog \$2.00 | Frito Pie \$2.50 |
| Nacho with Cheese \$2.25 | Nacho with Cheese and Chili \$2.50 |
| Cup of Chili \$1.00 | Snack size chips \$.50 |
| Regular size chips \$1.00 | Candy \$1.00 |
| Cotton Candy \$2.00 | Popcorn \$1.50 |
| Pickle \$1.00 | Bottled Water \$1.00 |
| Soft Drinks(Coke, Diet Coke, Sprite and Mr. Pibb) \$1.00 | |
| Coffee and Hot Chocolate \$1.00 | |
| Whip Cream and Marshmallows for Hot Chocolate \$.25 | |
| Lemonade \$1.00 | |